

“Stay Connected” with



HEYware Products

a PennEngineering® Company



HEYClip™ Heat Resistant, Shock Proof Snap Rivets

WILL FIT THESE PANELS						PART NO.	DESCRIPTION	PART DIMENSIONS						EXTRACTION FORCE		
MOUNTING HOLE DIA.		ASSEMBLED PANEL THICKNESS						Tan	A Length		B Head Height		C Head Diameter		(N)	STYLE
in.	mm.	in.	mm.	Min.	Max.				in.	mm.	in.	mm.	in.	mm.		
.083	2,1	.051	1,3	.079	2,0	11870H	SPPR 083-051 HR	.13	3,2	.05	1,2	.17	4,2	39	2	
.106	2,7	.134	3,4	.169	4,3	11873H	SPPR 106-133 HR	.22	5,5	.06	1,4	.20	5,0			
.122	3,1	.039	1,0	.079	2,0	11876H	SPPR 122-039 HR	.14	3,5	.07	1,7	.25	6,4	78	2	
		.079	2,0	.118	3,0	11879H	SPPR 122-079 HR	.18	4,5							
		.118	3,0	.157	4,0	11882H	SPPR 122-118 HR	.22	5,5							
		.157	4,0	.197	5,0	11885H	SPPR 122-157 HR	.26	6,5							
		.197	5,0	.236	6,0	11888H	SPPR 122-197 HR	.30	7,5							
		.217	5,5	.256	6,5	11891H	SPPR 122-217 HR	.31	8,0							
		.256	6,5	.295	7,5	11894H	SPPR 122-256 HR	.35	9,0							
		.295	7,5	.335	8,5	11897H	SPPR 122-295 HR	.39	10,0							
.142	3,6	.146	3,7	.181	4,6	11900H	SPPR 142-146 HR	.24	6,0	.07	1,8	.31	8,0	196	1	
		.177	4,5	.217	5,5	11903H	SPPR 142-177 HR	.31	8,0							
.161	4,1	.067	1,7	.098	2,5	11906H	SPPR 161-067 HR	.16	4,0	.07	1,8	.31	8,0	196	1	
		.177	4,5	.217	5,5	11909H	SPPR 161-177 HR	.28	7,0							
		.217	5,5	.256	6,5	11912H	SPPR 161-217 HR	.31	8,0							
		.256	6,5	.295	7,5	11915H	SPPR 161-256 HR	.35	9,0							
		.295	7,5	.335	8,5	11918H	SPPR 161-295 HR	.39	10,0							
		.354	9,0	.413	10,5	11921H	SPPR 161-354 HR	.47	12,0							
.201	5,1	.059	1,5	.098	2,5	11924H	SPPR 161-492 HR	.61	15,5	.09	2,2	.35	9,0	245	1	
		.098	2,5	.138	3,5	11930H	SPPR 201-098 HR	.22	5,5							
		.138	3,5	.177	4,5	11933H	SPPR 201-138 HR	.26	6,5							
		.177	4,5	.217	5,5	11936H	SPPR 201-177 HR	.30	7,5							
		.217	5,5	.256	6,5	11939H	SPPR 201-217 HR	.33	8,5							
		.256	6,5	.295	7,5	11942H	SPPR 201-256 HR	.37	9,5							
		.295	7,5	.335	8,5	11945H	SPPR 201-295 HR	.41	10,5							
		.492	12,5	.551	14,0											
.232	5,9	.118	3,0	.177	4,5	11948H	SPPR 232-118 HR	.25	6,3	.11	2,7	.47	12,0	294	1	
.240	6,1	.098	2,5	.157	4,0	11951H	SPPR 240-098 HR	.24	6,0							
		.138	3,5	.217	5,5	11954H	SPPR 240-138 HR	.31	8,0	.12	3,0					

Standard color tan (beige).

- Automotive tan (beige) color.
- Designed for fast and easy installation with no tools – just fingertip pressure required.
- Simply place rivet into the hole and press down on the head to fasten; legs expand to securely fasten components.
- Patented design where the Push Pin Head and Rivet Body interlock.
- To release, pull up on rivet head section.
- Round head provides a clean, finished look.
- Part Description Key: SPPR X-Y where X = Mounting Hole Diameter (inches) and Y = minimum Panel Thickness (inches).
- Standard Pack – 1,000/bag.

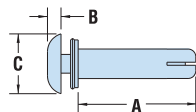

STYLE 1



STYLE 2



Material Nylon 4/6
 Flammability Rating 94V-2
 Temperature Range -40°F (-40°C) to 374°F (190°C)
 Heat resistant to 374°F (190°C).

Quick Specs